

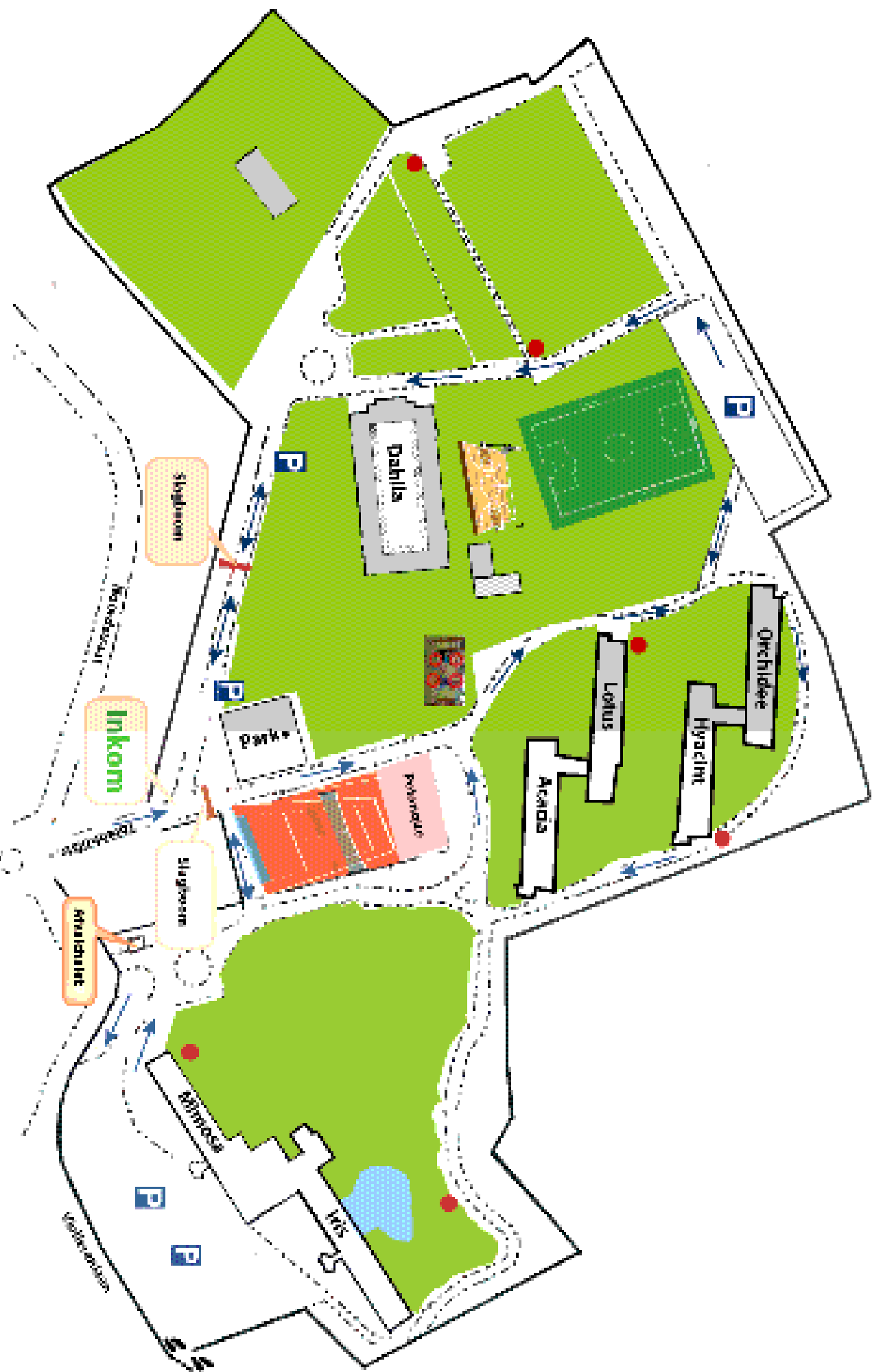

## *What you would like to know as a tenant of Park Atlantis*

We would like to welcome you in Park Atlantis and we hope you will enjoy your stay! The information below can be useful during your stay:

1. Questions? Your owner of the apartment is the first person to contact.
2. Map of the park: look at the reverse side.
3. Where to dispose your waste?
  - Take the yellow bag for garbage (with inscription of De Haan) to the waste chalet in the park (see map). The blue refuse bag for plastic, cans and beverage cartons needs also to be taken to this chalet. Paper and cardboard needs to be tied together or collected in a cardboard box. You can buy the yellow and blue refuse bags in the local shops In Vosseslag.
  - The dog poo tubes in the park are strictly meant for dog waste bags.
  - Please avoid litter in the park in order to respect the green environment.
  - Take the glass to the glass container. These are located in the vicinity of Dahlia on the one hand and ALHO (Acacia-Lotus-Hyacin-Orchidee) on the other hand. There is also a public glass container in Violierenlaan near Iris
4. Parking facilities? There are unlimited and free parking possibilities on the indicated spots in the park ( see map). Parking in the loading and unloading areas is restricted to 15 minutes.
5. Noise and nuisances rules: Show some respect at night by restraining the noise between 10pm and 8 am. Do not drop ashes of cigarettes on the terraces below your apartment. Do not feed the seagulls or other animals in the park. Dogs should always be kept on leash in the park.
6. Keys? You can open the entrance barrier with the white badge on the pillar at your left or with your key (the one for the waste chalet) next to the barrier itself. For Iris and Mimosa you need an extra badge to enter the residence.
7. Getting to know Vosseslag and De Haan? Check the map at the entrance.
  - There is a safe way to the beach: through the small gate at the parking space in front of the building Iris to the Violierenlaan. At the end of the street you go right into the Driftweg and then you take the first left where you cross the pedestrian bridge.
  - In Vosseslag you can find a few restaurants, a bakery, a grocery shop, a newsagent , a toy store and several others. A supermarket, a butcher, a bank and a bike rental are located in De Haan and Bre-dene. The tourist office in Vosseslag (Kennedyplein) will provide you with further information.
8. Sports and recreation in the park? There is not only a playground in the park but also lots of sports facilities such as tennis, basket, football, petanque, jogging and walking. Please note that dogs, skating and playing football are not allowed on the tennis courts.
9. Emergency? Call 112 or 100 for an ambulance, an emergency doctor or the fire brigade. Call 101 for the police. There's a pharmacy in Vosseslag: Kennedyplein 106A. There are also a few family doctors available in Vosseslag: Heidelaan 47 – on-call service: 059/239099.
10. For more information or for the entire welcome brochure please visit our website [www.parkatlantis.today](http://www.parkatlantis.today).



● — Istantenpoerbouzen - Citre pour depositions canines  
 Deep pour tubes - Hundepoo-Koestchen